

Pioneer Drive
BAPTIST CHURCH

PIONEER

POSSIBILITY



DEAR CHURCH FAMILY,

The numbers “20/20” generally remind us of near perfect vision. Today, as we enter the year of 2020, those numbers are linked to another kind of “vision.” The vision for the future facility needs at Pioneer Drive has come into sharp focus for us as we launch our capital campaign, Pioneer Possibility. The success of this vision that we believe God has revealed to our church will result in deeper discipleship and great Kingdom impact at Pioneer Drive and beyond. Through Pioneer Possibility, we will be able to broaden our ministries and strengthen our outreach capabilities.

The financial component of this campaign will rely upon three vital elements: talking to God about how He can use each of us to accomplish His will; listening to God to hear His voice and instruction; and being obedient to the Father however He may lead. In our sixty-five-year history, this has always been the formula. God’s people at Pioneer Drive have prayed and

been obedient, and God has blessed in remarkable ways. Let’s once again enter boldly into this endeavor, trusting in God’s provision and grace.

I am grateful to all who have had a part in assembling this Pioneer Possibility brochure. Please examine it carefully and prayerfully. Reflect upon God’s goodness in your life as you consider your part in this campaign. Whatever you decide to give is a personal decision between you and the Father. As each of us gives as He encourages, many will be blessed, including the giver. May the Father be honored and the Son be exalted as we are obedient to the Spirit’s voice.

For His glory,

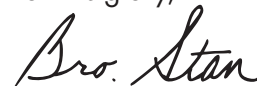

Pastor Stan Allcorn



WE ARE PIONEERS

We have an opportunity to lay a foundation for the next fifty plus years of faithfulness. At Pioneer Drive, we are dedicated to the education of God's truth and Word. We engage in passionate, corporate celebration. In these acts of worship, individual transformation occurs. And when lives are changed, families and communities are changed in radical multiplication of God's love and grace. We have an attitude of collaboration that allows for our blessings to bless others.

It's there in our name. We are pioneers. This is who God has called us to be. It's what He's called us to do. Are we going to respond in faith, or will we be the generation that wanders in the wilderness, wiped from the memory of history because of fear and inaction? God returns us to shared callings.







PHASE 1 PROJECT HIGHLIGHTS

- Increase the education space
- Add additional elevator access
- Connect the 240s with the 250s upstairs
- Pave the way for Phase 2, a new Sanctuary
- Updated Sunday School rooms with the latest technology capabilities
- Create more common areas for conversations and traffic flow
- Updated restrooms in a central location
- New building and restrooms ADA accessible
- Bring the Educational Building up to code
- Enclose staircases for safety and city compliance



BACK OF HOUSE

PLATFORM

WORSHIP CENTER
1,100 SEATS

ADMIN
3,672 sf

CAFE
2,266 sf

COMMONS
13,059 sf

STAIR
190.18 sf

EXISTING CHOR ROOM
2,237.27 sf

ELEV
143.88 sf

MEN'S
362.04 sf

WOMEN'S
407.78 sf

STAIR
197 sf

COMMONS
1,452.06 sf

CLASS
690 SF

CLASS
690 SF

CLASS
475 SF

CLASS
475 SF

STOR
138 sf

STOR
172 sf

CLASS
553 sf

CIRCULATION
1,365.92 sf

CLASS
412 SF

CLASS
412 SF

CLASS
412 SF

CLASS
412 SF

STAIR
174 sf

EXIST SANCT

LEGEND

EXISTING EXTERIOR WALLS
TO BE DEMOLISHED
10 CLASSROOMS TOTAL ON THIS FLOOR

SCALE: 1/16" = 1'-0"

MASTER PLAN: FIRST FLOOR

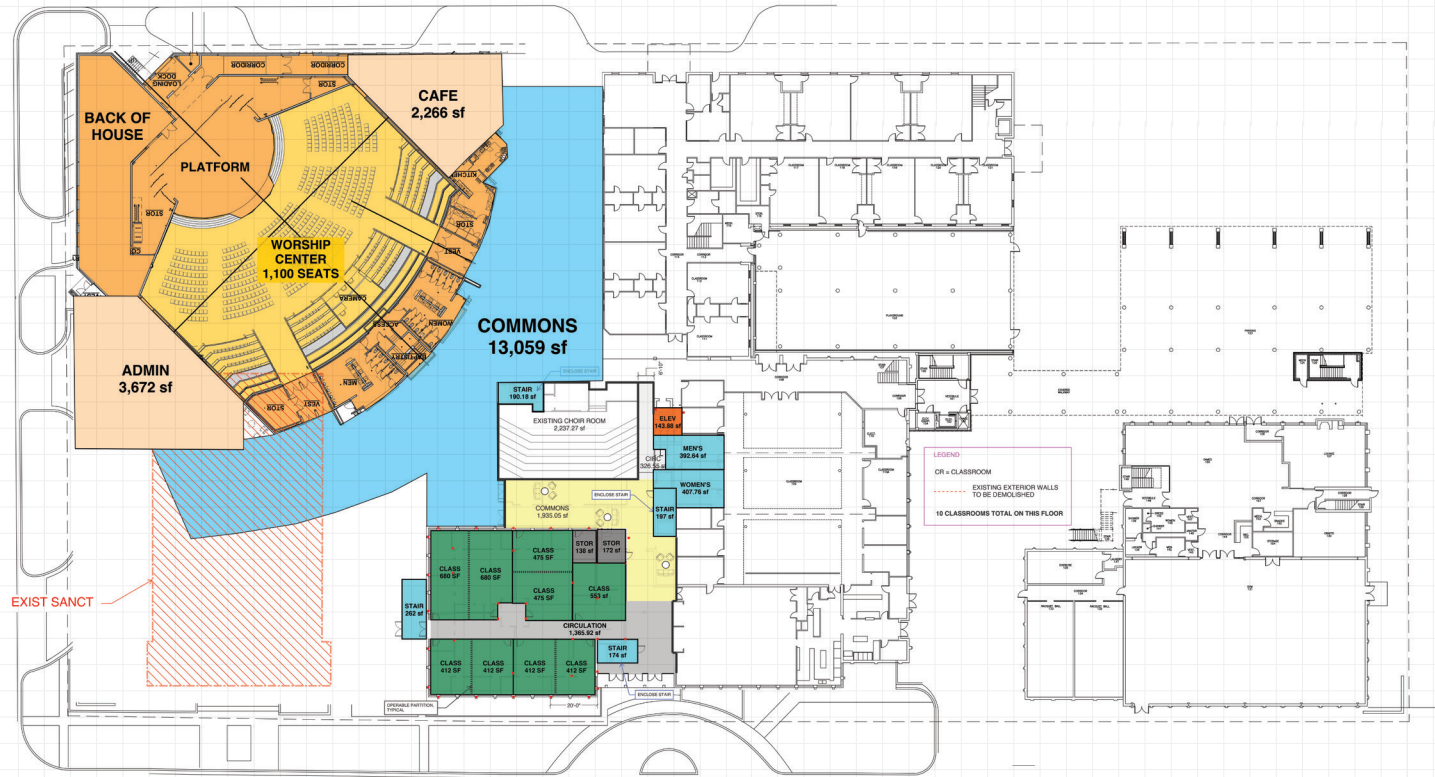

SCALE: 1/16" = 1'-0"

MASTER PLAN: SECOND FLOOR

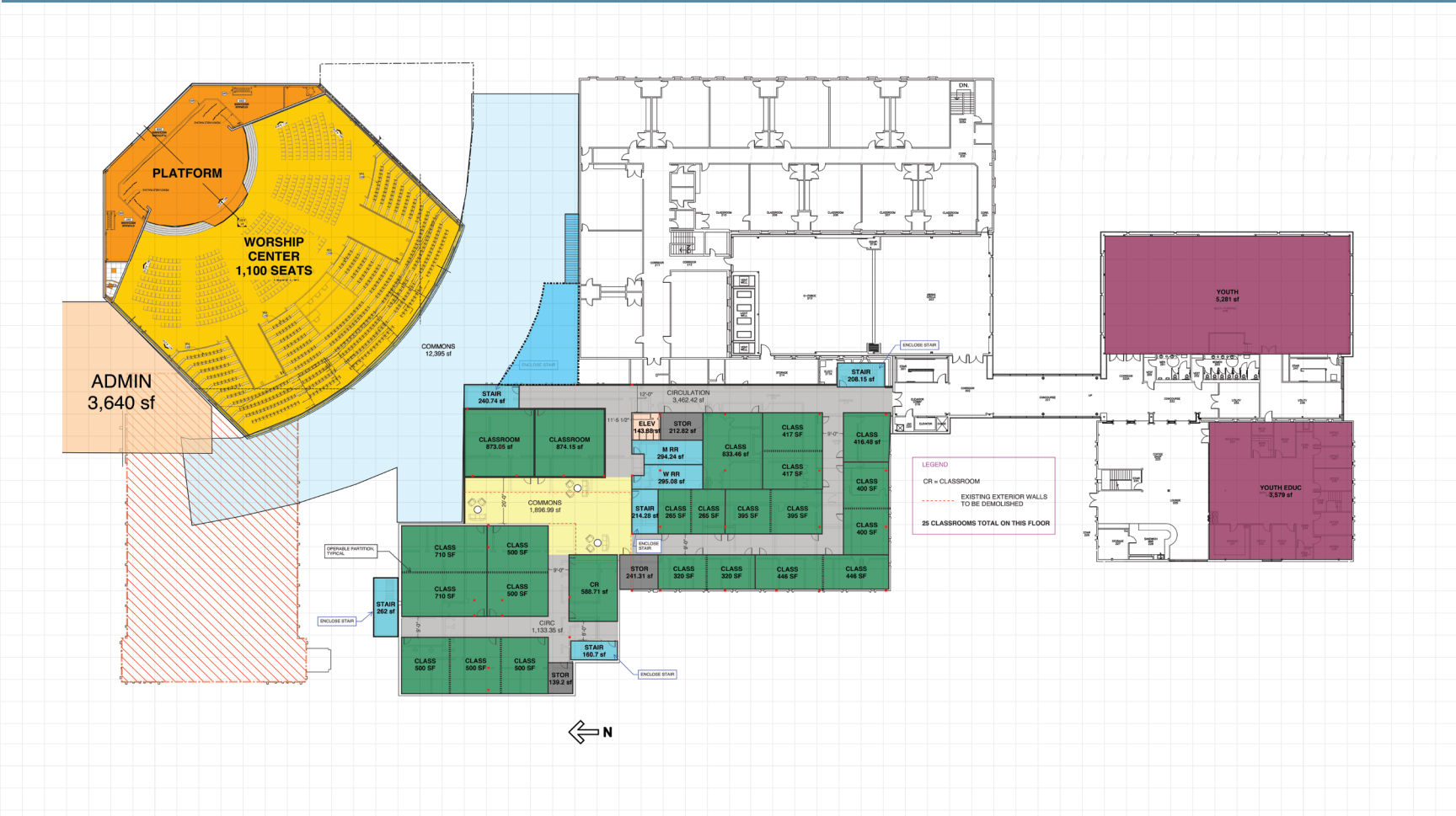



FREQUENTLY ASKED QUESTIONS?

WHAT IS THE PURPOSE OF THE CAMPAIGN?

We see an opportunity before us to have a transformational, kingdom impact on the Big Country and beyond.

HOW WILL BUILDING HELP US REACH OUR COMMUNITY FOR CHRIST?

Our renovated facility will reclaim unusable space into rooms that will be open for all to come and study the way of Jesus together. With this new space, we will have the opportunity to grow our Sunday School ministry by inviting our friends and neighbors to join us in an innovative space that will be used to develop disciples.

HOW LONG IS THE CAMPAIGN SCHEDULED TO RUN?

Three-years beginning March 2020 and concluding February 2023.

WHAT IS THE TOTAL CONSTRUCTION COST ESTIMATE OF PHASE 1?

The total project cost is estimated to be \$4.5 MM. Contingency was added for extras (e.g. 250s need a new roof), cost overruns and increased material costs.

HOW WILL WE PAY FOR THIS?

With God's guidance and the sacrificial giving of Pioneer Drive, we believe the challenge can be met, and Pioneer Drive will leave a legacy of faithfulness of generous, gospel-centered living.

HOW CAN I HELP?

- First and foremost, pray regularly for our "Pioneer Possibility" campaign.
- Participate in the events and meetings.
- Make a commitment to learn as much as you can about the campaign and the vision it will help us realize.
- Give sacrificially. The vision God has granted us can only be achieved through faith and sacrifice. We have the privilege to be a part of growing His Kingdom through Pioneer Drive.



HOW HAS PIONEER IMPACTED YOUR LIFE?

DOROTHY KISER – “It’s hard for me to imagine my life without Pioneer Drive where I have been a member for over forty years. Many of my close friends and much of my social life revolves around Pioneer Drive. Primetimers, my Sunday School class, and the Women’s Ministry provide many opportunities that I participate in. The people are very special to me. I love worshipping in the Celebration service.”

JAY AND WILMA BARBIAN – “We have been members at Pioneer Drive for over 40 years and have watched her grow in many ways. We have always been a fellowship that sought God’s Will and tried to plan accordingly, this step of faith is no different. We feel this is a step in the direction of further unifying our members by combining into one Sunday School and getting to be a closer fellowship. We trust that God has His hand in this plan and will lead all the way.”

PAUL AND MOLLY LENKER – “We love Pioneer Drive and all it means to us and our family. We will support this campaign and encourage others to do so. For us, this campaign is an opportunity to reach others for Christ, to help make a place for not only our current congregation but for those yet to come, to become part of the legacy of Pioneer Drive and to touch the future. Most importantly, it is to show obedience to God’s commands—to spread the Gospel of salvation through Jesus Christ. To be a part of this church’s growth is our privilege, our responsibility, and our joy.”

RICK CASON – “The Pioneer Drive family has walked life with me in so many different fashions. They welcomed us in with open arms back in 1969, and quickly took us in as a part of the family. This “family” has walked beside me and held me in the mountain top experiences of my life as well as the deepest valleys of my life and everywhere in between. I can’t imagine my life without Pioneer Drive. There are many other churches, but this place is SPECIAL!!! This is my second home, my family. I love Pioneer Drive!”

JEFF MCMILLON – “It’s hard to imagine what our lives would be like without Pioneer Drive. We have seen God at work in our lives through this church body...through good times and tough times...through times of plenty and times of drought. This church has celebrated with us and cried with us; everyone at Pioneer Drive can say the same. What would our lives be like without Pioneer Drive? I honestly don’t know...but it’s been great with Pioneer Drive!”



DETERMINING WHAT TO GIVE

Want to be involved but not sure where to start? Prayerful conversation with the Lord, your family, and your peers remains critical. Ask the Lord, and be confident in His direction: *"God, what do You want to do through me to accomplish Your will in my church?"*



FIRST, DISCUSS.

Your treasure is already where your heart is; ask yourself if both are submitted to His Lordship. Bringing your requests to God and receiving wisdom from Him is every believer's privilege and responsibility. He wants to reveal His heart and His will to you; be proactive and ask Him.



THEN, DECIDE.

Giving out of your income is a great place to start; perhaps it's a unexpected financial blessings that could be set aside. Consider assets: did you know you can give land or a home directly to your church and avoid paying any capital gains tax while still getting a fair market value deduction? Then there's "stuff": you move it, you store it, you insure it, and you dust it. Perhaps you could give it? Most importantly, consider a sacrificial gift. Set aside funds you normally would have spent on something you can do without or even something you think you can't.



NOW, DO!

Follow through! Faith without works is dead; we must set it in motion to produce its results. Making a commitment is about anticipating what God will do with what you give through your humility and obedience, not about how or how much you give. Your job is to ask, listen, and respond. His role is to bring seed to the one who would sow. He is faithful, and we are to likewise model that faithfulness.

\$4 MILLION

\$6 MILLION

\$8 MILLION

CAMPAIGN GOALS

BUILDING AND PLANNING FOR THE FUTURE REQUIRES WISDOM, PRUDENCE AND FAITH.

The campaign leadership team has been seeking wisdom and praying earnestly to hear and discern God's will in this campaign. As a result of that study and prayer, the team set three progressive goals for the three-year campaign. The first goal is set at an attainable \$4 million. The second goal takes great faith, set at \$6 million. Our third goal of \$8 million is attainable as well, when we pray for God's miraculous intervention and commit ourselves to extraordinary generosity and sacrifice with our finished goal in mind. After all, we serve a BIG & MIGHTY God and with Him, we can do BIG & MIGHTY things!

In celebration of God leading us through this journey, our church family will turn in commitment cards together on March 1st during our morning worship services. Then we will take the next step as we put our faith in action and watch God fulfill His vision for our church. On Sunday, March 22nd, we will share the results of our efforts and give thanks to the Lord. Your commitment card is not a binding contract, but rather a declaration of your intentions, which will help the church plan.

Ways to submit your commitment cards:

- **Participate.** Turn in your commitment cards with your Pioneer family on March 1st.
- **Mail.** Mail in your commitment card using the envelope provided to you.
- **Electronically.** Visit the campaign website found at www.pioneerdrive.org and submit your card electronically.

All commitments are strictly confidential.

COMMITMENT CARD



Understanding that all I/we possess is a gift from God,
I/we rejoice in the privilege to participate in the
Pioneer Possibility project.

MY/OUR THREE-YEAR COMMITMENT IS

\$ _____ Weekly x 156 weeks or

\$ _____ Monthly x 36 months or

\$ _____ As follows _____

\$ _____ **TOTAL**

COMMITMENTS OTHER THAN CASH

\$ _____ Approximate value of gift(s)

TOTAL COMMITTED

\$ _____

I/we will begin my/our gifts on _____

Name _____

Phone _____

Email _____

SIGNATURE(S)

NOTE: This is a statement of intent and may be altered as circumstances warrant.

Pioneer Drive
BAPTIST CHURCH

701 S. PIONEER DR., ABILENE, TX 79605

NON-PROFIT ORG.
U.S. POSTAGE
PAID
ABILENE, TX
PERMIT NO. 181

WE WANT TO PERSONALLY INVITE YOU TO BE AT
PIONEER DRIVE ON MARCH 1ST FOR COMMITMENT SUNDAY.